



# Big Dutchman®



## **NATURA® Sunrise**

Multi tier open aviary layer system



# NATURASunrise

- Completely open design for easy movement throughout the entire system
- Patented tiltable nest design
- Zn-Alu® wire coating allows for a clean system
- Extra-wide egg belt
- Easy to manage design

## ORGANIC CAGE-FREE AVIARY SYSTEM:



For those who require organic cage-free certification, the NATURASunrise is the ideal system with a completely open design offering your flock the ability to move freely.

- System design encourages bird movement, resulting in quality litter in the litter aisles
- Management of the system can be done from the litter aisles
- Easy access to fresh feed and water

## PERCHES AND PERCH PLACEMENT:



Perches allow your flock to have a place to relax, and the design of the perches provide comfort. The placement of perches encourage flock movement which relaxes the flock, and at the same time maximizes proper air circulation, resulting in a healthy and comfortable environment.

The patented approach perch is designed to protect any mislaid eggs. It also positions the hens to face outside of the system while roosting, allowing the manure to fall onto the manure belt, resulting in lower ammonia levels and a cleaner system.



## QUALITY LITTER:

Uniformity of lighting and ventilation, along with the system design, encourage even spacing of the hens throughout the house, creating optimal litter conditions.

This is ideal for the flock as they act out their natural behaviors. The hens will pay more attention to the litter and less to each other, resulting in a calm and healthy flock.



### FRESH FEED FROM OUR CHAMPION® CHAIN FEEDING SYSTEM:

The Champion chain feeding system presents feed at pre-set levels and allows birds easy access to feed. An extra wide trough and special lip design keeps feed in front of your hens, maximizing feed conversions.



### EASY ACCESS TO FRESH DRINKING WATER:



The hens have 360° access to fresh drinking water throughout the system. Each compartment is equipped with stainless steel nipples, providing every hen with easy access to water at any time. Drip water cups prevent corrosion and help to keep the manure dry.

### NEST ENVIRONMENT, DESIGN AND EXTRA WIDE EGG BELT:

The nest environment consists of a staging area, fresh drinking water, and the nest. The staging area is for the birds as they wait to enter the nest and as they leave the nest. The tilting nest floor and central egg belt work together to maximize egg production



Nest staging area for birds as they wait to enter the nest, and for birds to have a drink as they leave the nest



Extra-wide center located egg belt allows room for eggs to roll out, resulting in less cracks

### OPERATION OF THE TILTING NEST FLOOR (PATENT-NO. EP 1 086 623 A2)

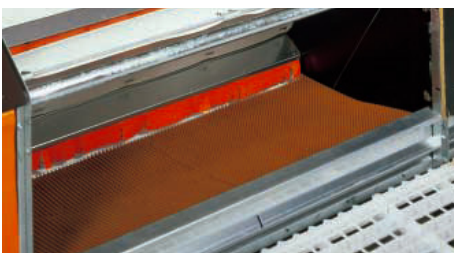

The egg belt is located in the center, allowing the eggs to be laid directly in front of the belt. This design ensures the shortest possible roll-off distance for the eggs, **minimizing the amount of cracked and checked eggs.**

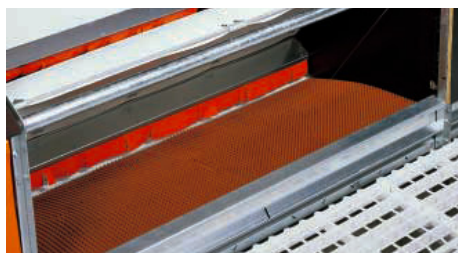

Before the divided nest floor completely closes, it is first raised in the center slightly, which **provides a gentle egg roll off onto the center egg belt.**



The nest floor is raised completely, allowing any dirt to drop off the nest insert, and closes off the nest to **prevent hens from entering and brooding inside.**

## SYSTEM MANAGEMENT:



With our NATURA cage-free systems, flock inspection, gathering mis-laid eggs, nest, feed and water inspection can all be done by walking the litter aisles.

**Waste management:** Proper manure drying reduces ammonia emissions in the house, minimizing any harm to the environment, and promoting the birds' well-being.

Manure drops through the Zn-Alu coated floor onto continuous polypropylene belts, and is then carried out of the building.

## SYSTEM PROFILE:

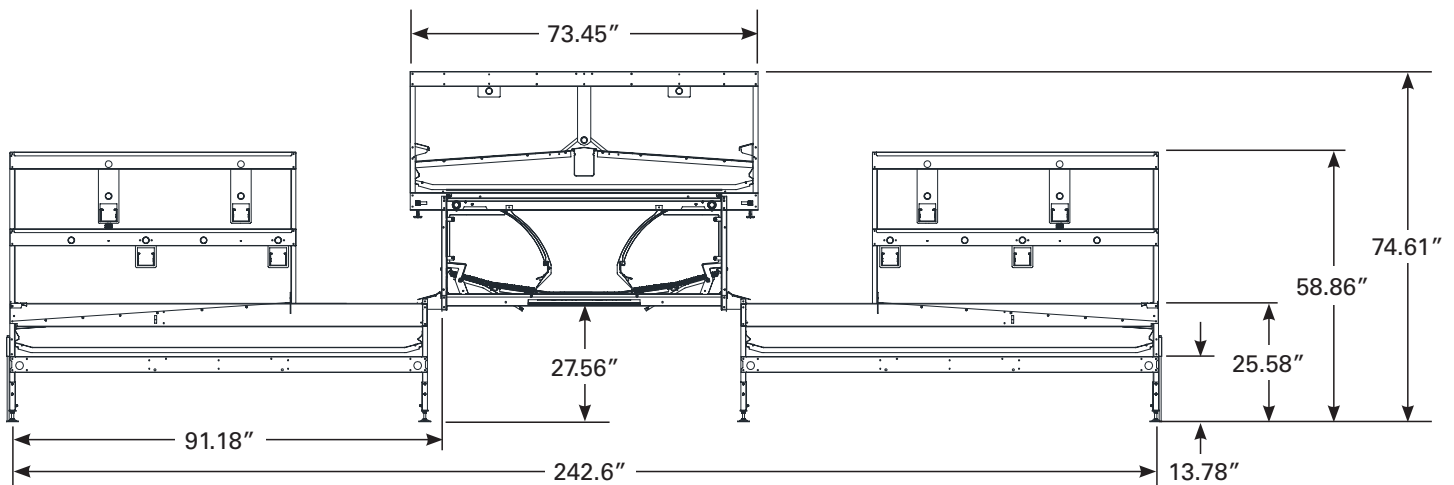

Section length: 94.96" (241.2cm)



**Big Dutchman**

For USA, Canada and South America please contact:

**Big Dutchman, Inc. - USA**

3900 John F Donnelly Dr • Holland, MI 49424 • USA

tel +1 616 582 4000 • fax +1 616 392 6188

www.bigdutchmanusa.com • info@bigdutchmanusa.com

Technical details are subject to change. 7/2017

86-00-6177